



SERIES 24 SWING CHECK VALVES PFA LINED



DN50 - DN400

FEATURES & BENEFITS

- Fully encapsulated one-piece disc / hinge assembly
- Suitable for PTFE lined or unlined pipework in severe process conditions
- Robust design
- Durable, high cycle performance
- 'T-Slot' liner locking system
- Virgin PFA

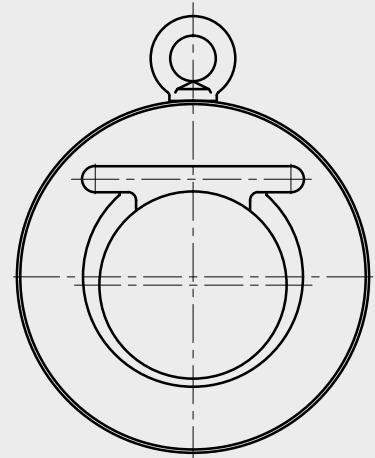
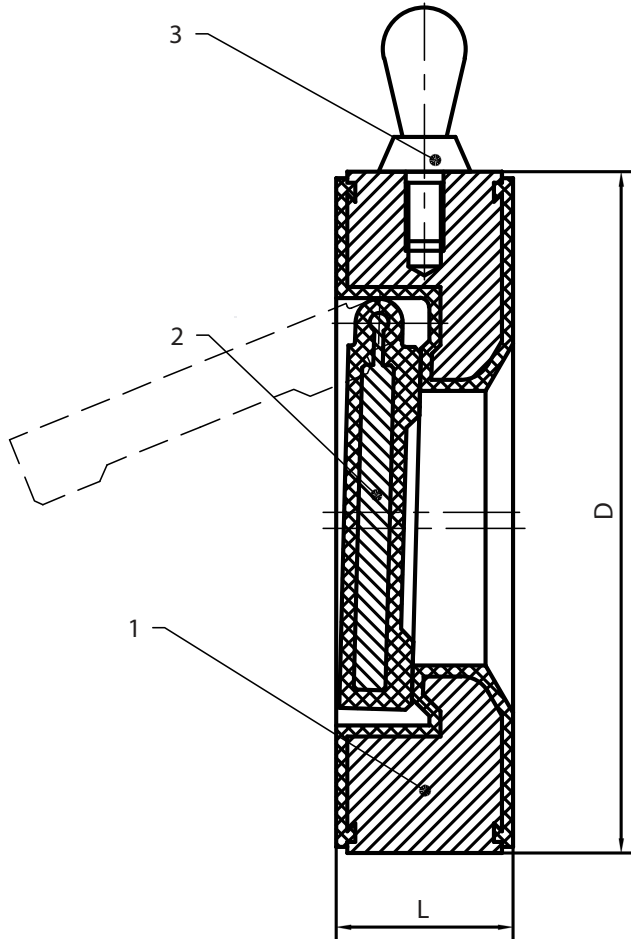

Materials of Construction

1	Body	Cast Steel	ASTM A216 WCB+PFA
2	Disc	Cast Steel	ASTM A216 WCB+PFA
3	Lifting Bolt	Carbon Steel	SS304

Dimensions

DN	L	D
50	46	100
80	46	133
100	52	162
125	56	189
150	56	216
200	60	272
250	68	320
300	78	386
350	78	435
400	102	488

Standards

TEST PRESSURE	SHELL		SEAL
	Water	1.5 MPa	
Air			0.6 MPa
STANDARD	DESIGN & MANUFACTURE		HG/T 3704
	INSPECTION AND TEST		API 598
	FLANGE		ASME B16.5
	FACE TO FACE		HG/T 3704

FAST TRACK

In house manufacture and stock holdings allow KDV to deliver quickly, and reliably facilitate fast-track projects. Visit our website for information on the full range of KDV Diaphragm Valves.

www.kdvflow.com