



**SERIES 23  
DUAL PLATE CHECK VALVES  
DN50-DN600**

ENGINEERED EXCELLENCE



**DESIGNED TO PERFORM**

- Simple design
- Robust construction
- Dual plate operation

**DUAL PLATE  
CHECK VALVE**



# DUAL PLATE CHECK VALVES

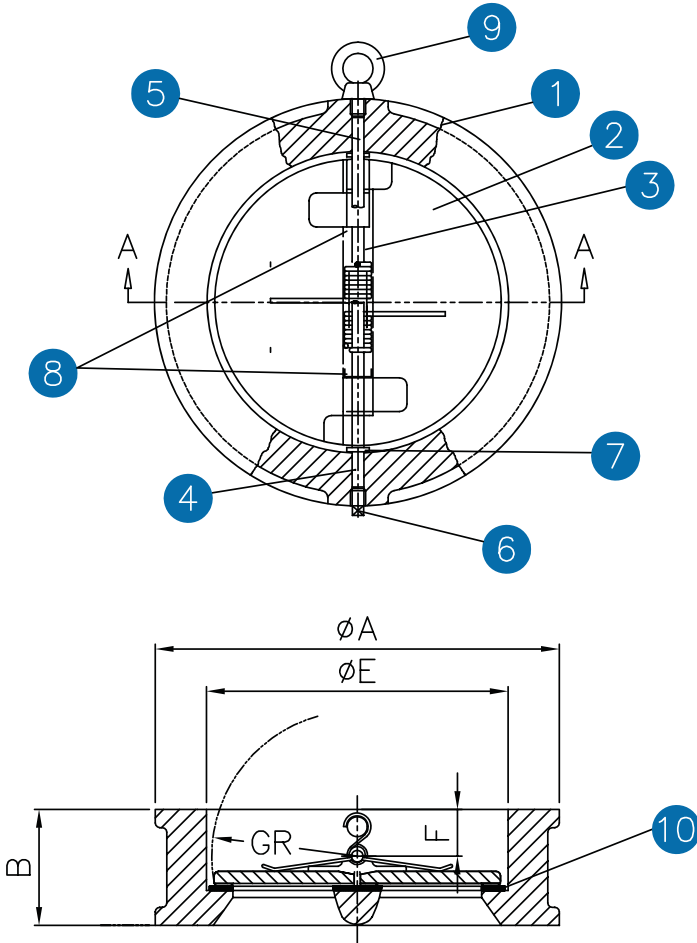

KDV Dual Plate Check Valves are engineered to ensure long service life and reliable operation. Dual plates provide maximum strength and faster

- Simple design
- Robust construction
- Fast operation

## Materials Of Construction

PART	MATERIAL
1. Body	Cast Iron, Ductile Iron
2. Plate	CF8M
3. Spring	SS316
4. Hinge Pin	SS316
5. Stop Pin	SS316
6. Plug	Carbon Steel
7. Body Bearing	PTFE
8. Spring Bearing	PTFE
9. Eye Bolt	Carbon Steel (DN200 - DN600)*
10. Body Seat	EPDM/NBR/VITON

\*If requested

## Dimensions & Weight

	øA	B	øE	F	GR
DN50	96	43	65	19	28.8
DN65	109	46	80	20	36.1
DN80	128	64	94	28	43.4
DN100	160	64	117	27	52.8
DN125	192	70	145	30	65.7
DN150	213	76	170	31	78.6
DN200	270	89	224	33	104.4
DN250	334	114	265	50	127.0
DN300	380	114	310	43	148.3
DN350	444	127	360	45	172.4
DN400	496	140	410	52	197.4
DN450	559	152	450	58	217.8
DN500	617	152	505	58	241.0
DN600	724	178	624	73	295.4

TEST PRESSURE	SHELL		SEAL
	HYDROSTATIC	24 kg/cm <sup>2</sup>	17.6 kg/cm <sup>2</sup>
	AIR	6 kg/cm <sup>2</sup>	6 kg/cm <sup>2</sup>

STANDARDS	DESIGN & MANUFACTURE	
	INSPECTION & TEST	API 598
	END STANDARD	AS 2129 (BS10) TABLE E
	FACE TO FACE	DIN 3202 K3

## Applications

Suitable mediums include:  
Fresh water, Sewage, Sea water, Air, Steam, Food,  
Medicine, Oils, Acids, etc.